

ARKUS HORIZONT

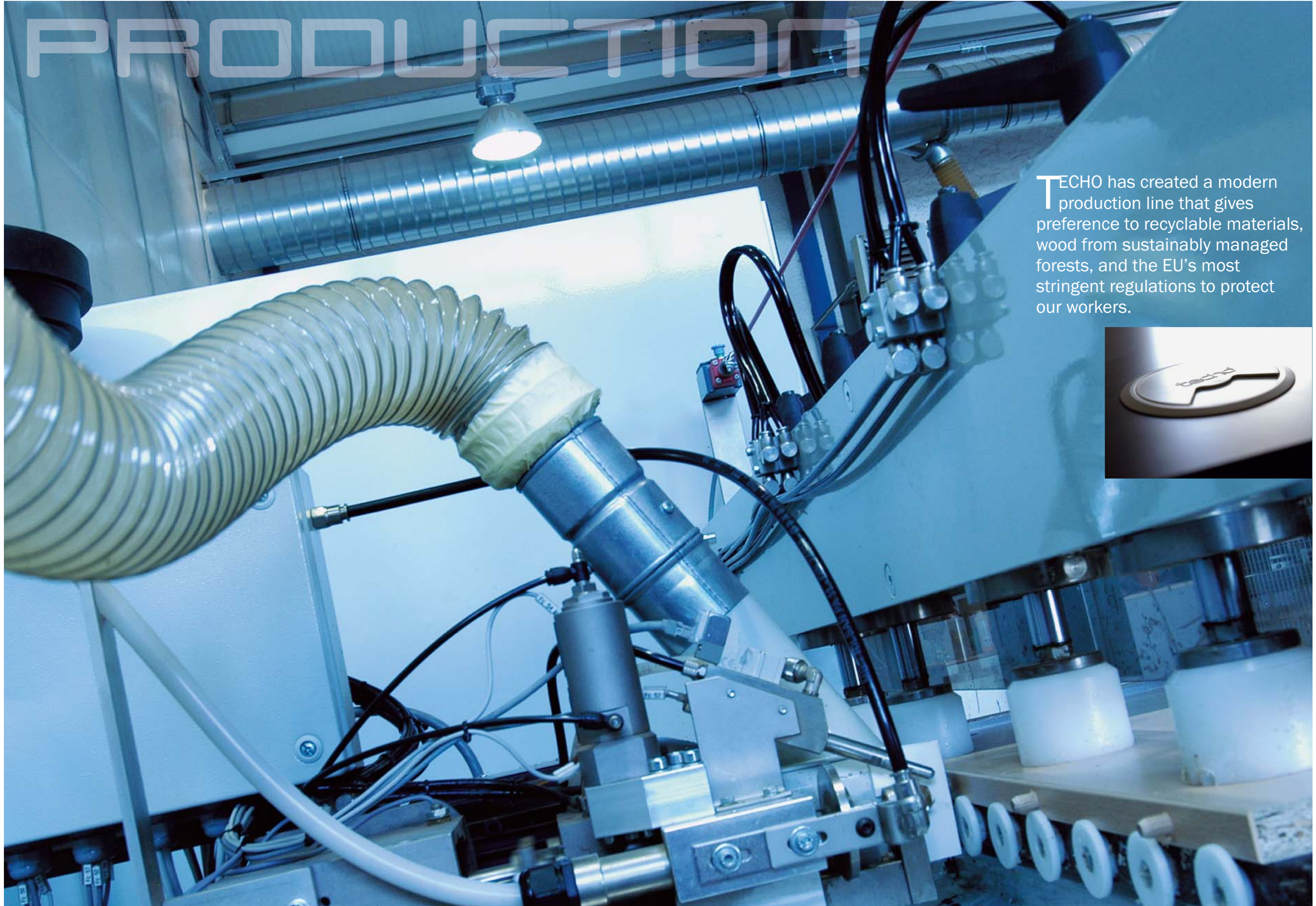

PRODUCTION

TECHO has created a modern production line that gives preference to recyclable materials, wood from sustainably managed forests, and the EU's most stringent regulations to protect our workers.



ARKUS



Created by award-winning Dutch designer Hans Verboom, the **Arkus A** desk range has the elegant look of a minimalist classic. When asked why the Dutch are internationally famous for design, Verboom offers, „in my country, everything, even the horizon, is designed.“ Because of this attention to every detail, Techo has sold nearly 200,000 Arkus workstations over the years.



“ I am not a perfectionist in aesthetics or technology, but I am a perfectionist in being practical. That’s my quest for perfection – to find the most practical solution for this moment knowing that time changes things ever more rapidly and that change is the only constant in our lives. ”

HANS VERBOOM



Designed by
Hans Verboom



Arkus desks are distinguished not only in the perfection of their design, but also in the simplicity of their configuration. Because so few parts are needed in our special beam system, the desks are sturdy and easy to reconfigure, key requirements in today's rapidly changing business environment.



ARKUS



Worksurfaces

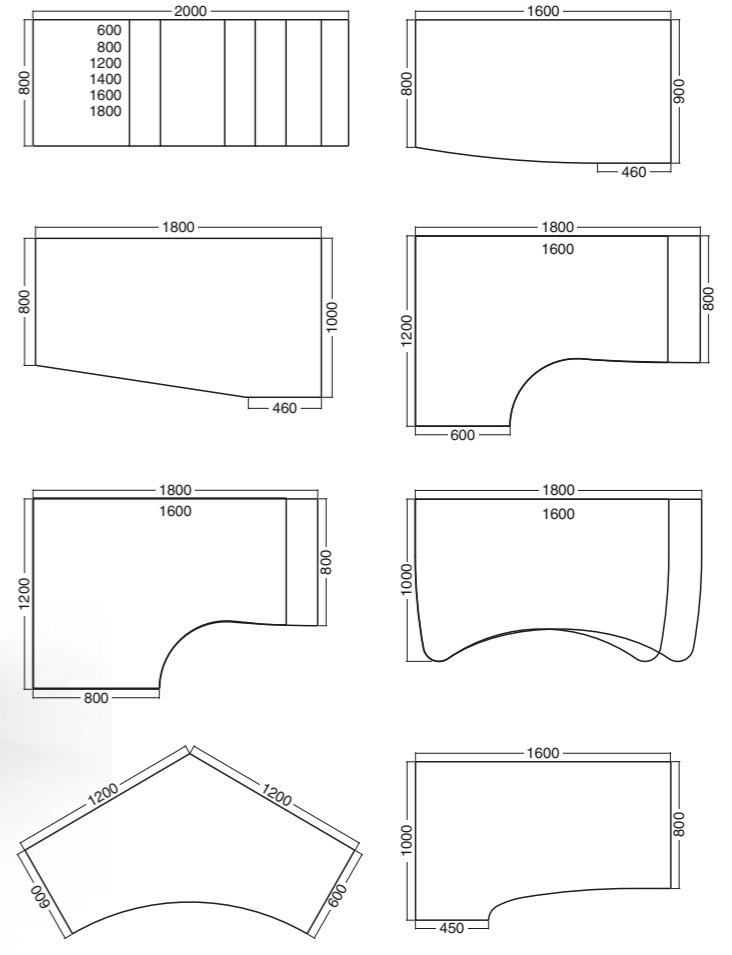

Worksurface extensions

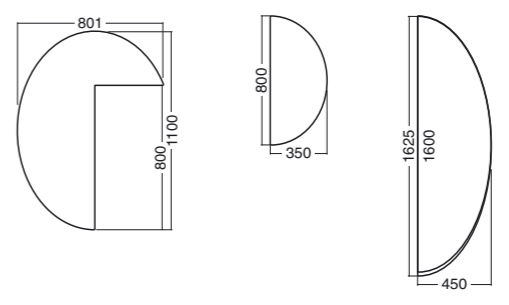

Certificates
 EN 527-2
 ISO 9001
 ISO 14001
 OHSAS 18001
 CFCS 1004
 FSC STD 40-004
 Furniture Industry
 Sustainability
 Programme -
 Full Member

worksurface finishes

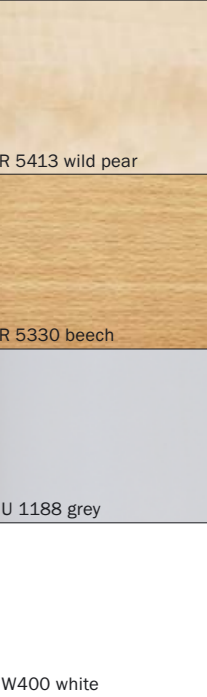

frame finishes

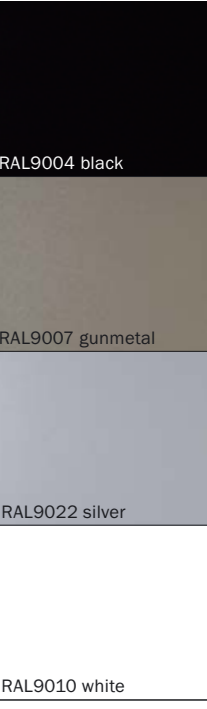

Worksurface options

Finished in grey, beech, wild pear or white using extremely durable MFC or Ekotech, desks are sized and shaped according to real working needs.

ARKUS



Edge protection

Desk edges are vulnerable to damage so we provide two solutions: ABS edges or Ekotech with varnished edges.

Profiled steel legs

Clients can choose between C and A leg designs.

ARKUS



Arkus C desks adapt their large worksurfaces to many office needs and environments. This flexibility has made them a favourite with architects and designers.



Designed by
Hans Verboom



“The Arkus system is a worthy enhancement to office environments where a high value is placed on elegant looks and flexibility.”
HANS VERBOOM





Arkus desks are so versatile that they can be configured to serve as office desks, conference tables, or call centre workstations. Elegant enough for senior managers with private offices, our desks are also ideal for open space offices.



ARKUS



Worksurfaces

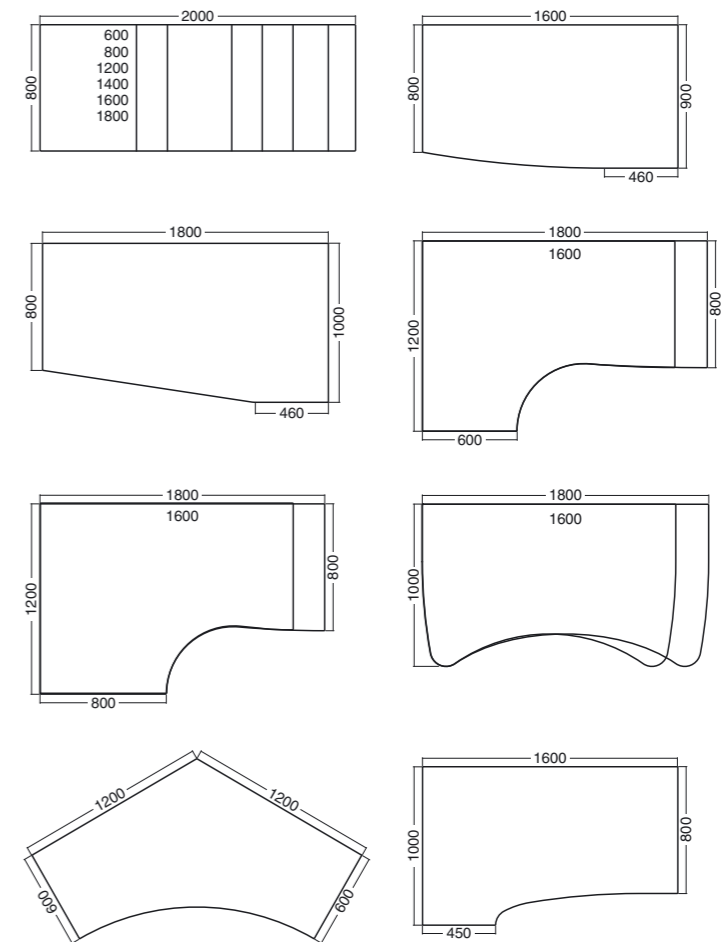

Worksurface extensions

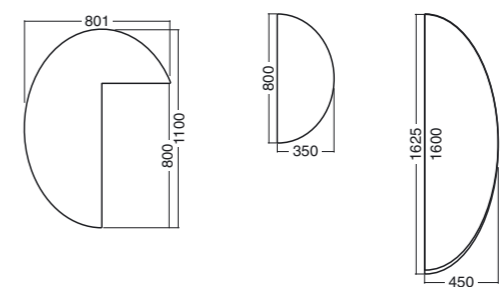

Certificates
 EN 527-2
 ISO 9001
 ISO 14001
 OHSAS 18001
 CFCS 1004
 FSC STD 40-004
 Furniture Industry
 Sustainability
 Programme -
 Full Member

worksurface finishes

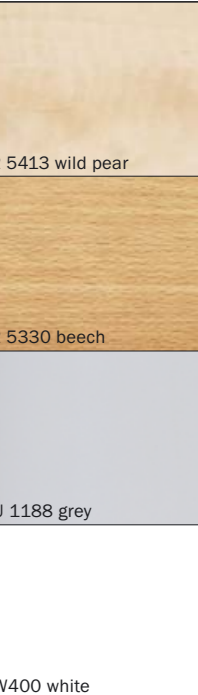

frame finishes

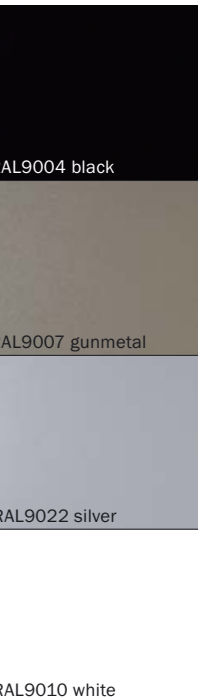

Height flexibility
Both C and A legs
allow adjustments
in height
from 735 to 750 mm.

ARKUS

Putting together a large
conference table for your boardroom
is a simple job for **Arkus**,
with its easily configurable tops
fitted to structural beams.

Cable management
Our special beam design
leads to efficient and
hidden placement of all
cables, avoiding clutter
on the desk surface.

HORIZONT



With its slightly slimmer profile, **Horizont** provides a new aesthetic option for managing your office tasks and utilising your space.



Designed by
ADR Studio
– Aleš Lapka, Petr Kolář



“Simple form and attention to function are the principles applied to this design. As a result it has the elegance and timeless character that have become the TECHO hallmark.”
ADR

HORIZONT



Horizont offers several options for cable management, all of which are concealed under the desktops to ensure that no cables interfere with the important tasks at hand.



Worksurfaces

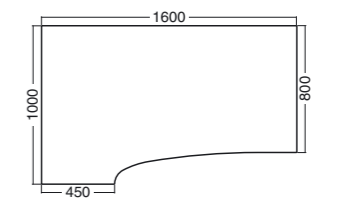
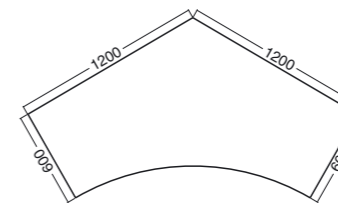
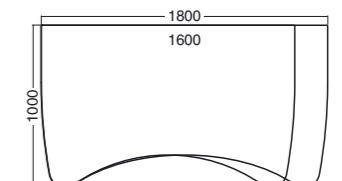
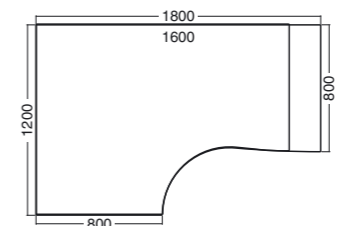
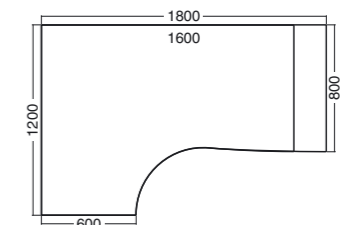
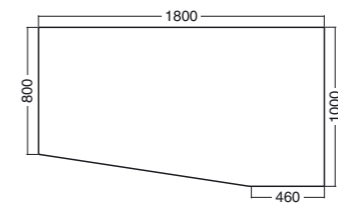
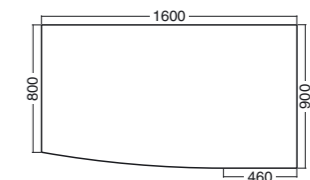
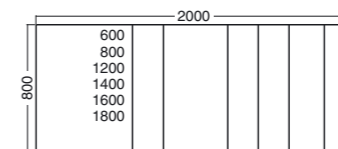

Worksurface extensions

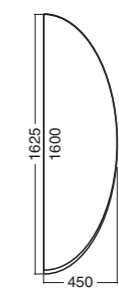
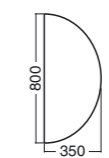
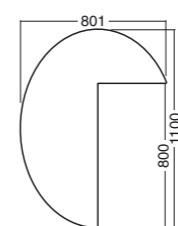

Certificates
 EN 527-2
 ISO 9001
 ISO 14001
 OHSAS 18001
 CFCS 1004
 FSC STD 40-004
 Furniture Industry
 Sustainability
 Programme -
 Full Member

worksurface finishes

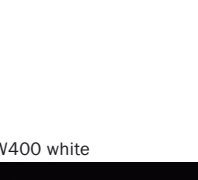
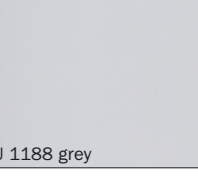
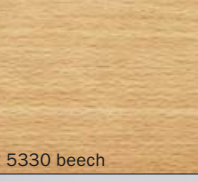
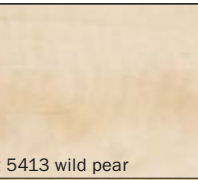

frame finishes

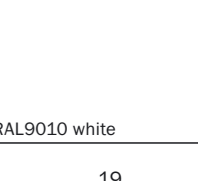
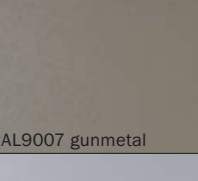
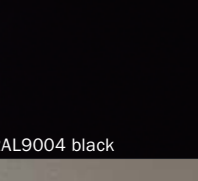

Screens

The fabric covered screens provide a certain degree of privacy and thus aid concentration. The upper grooved profile can also be used for attaching office accessories.

Some people say aesthetics shouldn't influence your desk layouts, but the working mind reacts well to subtle design decisions. Take this view: a building has an external rounded profile. Why not match this rounded profile with your desks inside? Thinking both inside and outside the box is the surest route to success.

HORIZONT

Worksurface Extensions

Allow offices to be customised according to requirements so that employees who need a lot of space can be accommodated easily beside those who don't.

Storage Units

Sit easily beside the adjustable legs, with matching colour finishes.

ARKUS HYBRID

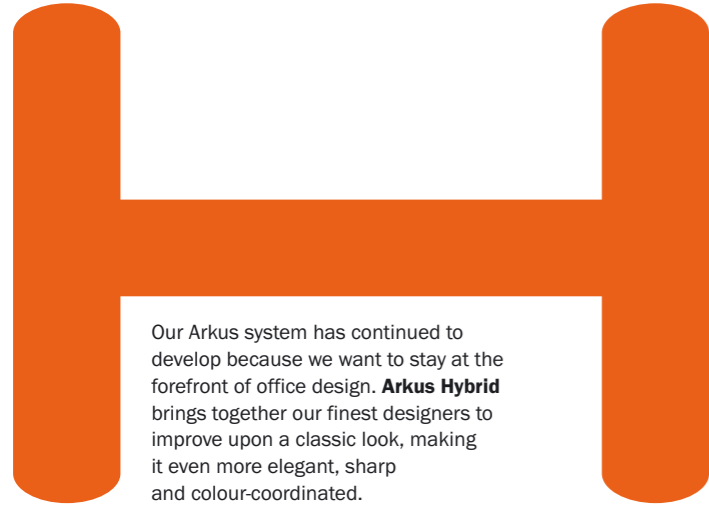

Our Arkus system has continued to develop because we want to stay at the forefront of office design. **Arkus Hybrid** brings together our finest designers to improve upon a classic look, making it even more elegant, sharp and colour-coordinated.



“ We designed this version of the Arkus range to meet customer requirements for integrated storage and seamless desk extensions. It further proves the versatility of Arkus and provides architects and designers with a range of new options. ”

BARRY FOLEY



ARKUS HYBRID

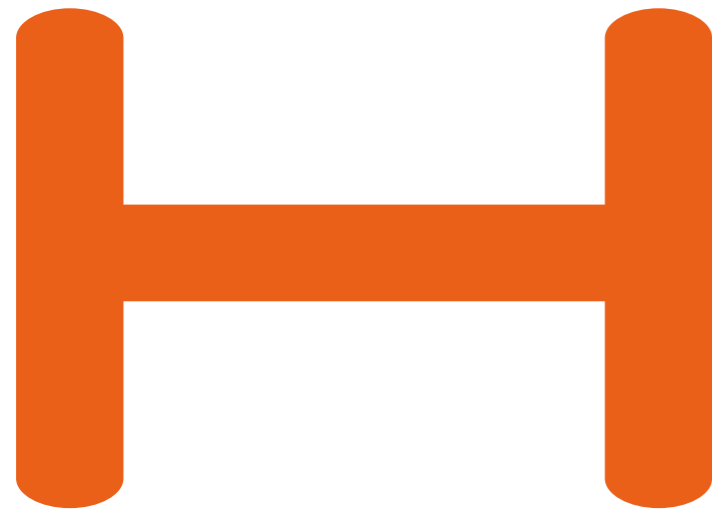

Desk tops in many shapes are available because different jobs and tastes need accommodating. When office workers feel comfortable at their desks, they are much more productive. Ergonomics is about efficiency as well as comfort.



Worksurfaces

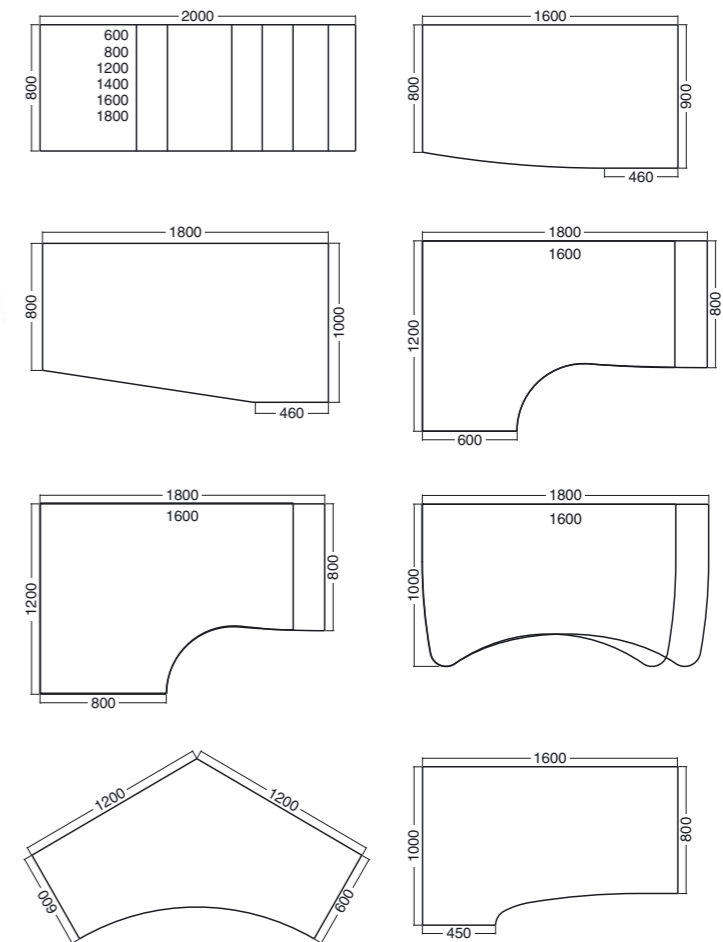

Worksurface extensions

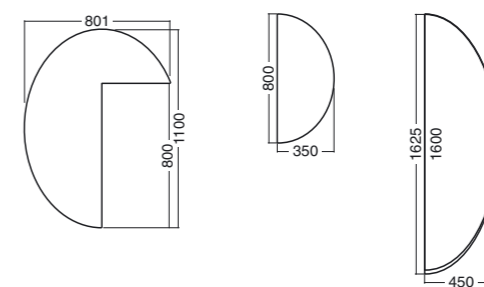

Certificates
 EN 527-2
 ISO 9001
 ISO 14001
 OHSAS 18001
 CFCS 1004
 FSC STD 40-004
 Furniture Industry
 Sustainability
 Programme -
 Full Member

worksurface finishes

R 5413 wild pear

R 5330 beech

U 1188 grey

W400 white

frame finishes

RAL9004 black

RAL9007 gunmetal

RAL9022 silver

RAL9010 white

Storage Unit B

Our second storage concept brings in desk high units, effectively extending the available workspace.

ARKUS HYBRID

We will adapt our products to your needs. Techo is primarily a project furnisher rather than a furniture retailer, and meeting the specific needs of clients is what we have built our reputation on.

Storage Unit A

Storage units are flexible in function: some fit as an under-desk element.



SUSTAINABILITY



Sustainability has to start with the intelligent linking of design with the actual production process in our factory. Techo makes maximum use of recycled materials and uses only sustainably harvested wood. In the CEE Techo leads the way in demonstrating its environmental credentials through participation in international certification schemes.

Human anatomy is restricted in ways that make it move beautifully. Why not choose office furniture that moves naturally with the human body? Ensure the comfort of your staff by adapting our products precisely to their needs.

ERGONOMICS

ERGONOMICS

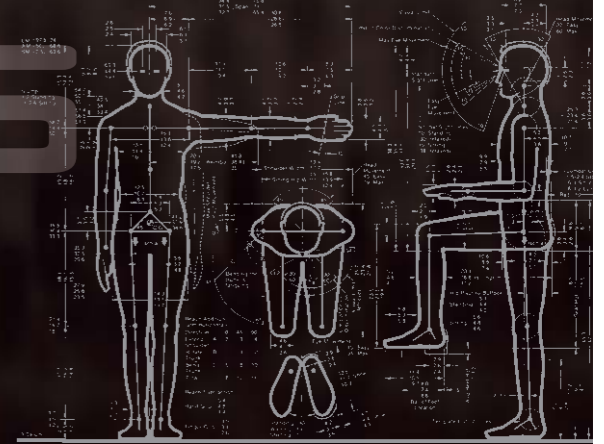

She: Why are your interiors
so nondescript and grey?
He: That's a beautiful orange outfit
you're wearing, it really suits you.
She: Thank you.
He: Do you think I'd have said
that if we were
in a bright green interior?

INTERIORS

white
yellow
red
blue
black



Space for colour

To talk about colour in architecture is to talk about light. The basic structure I work with has six walls, in my conception with the simplest forms possible, determining the way in which the space is to be used. As many transparent materials as possible, to let in light! The interplay of light and the plastic form of the components of a construction is a wonderful set design, a space for colour.

I like making photographic documentation, recording the moments when a building is now standing, but is not yet in use. It is a situation loaded with an infinite number of potential meanings, and - for the perceptive viewer - offering the eye new sensations of colour!

It is of course a time when Chochol's "do not seek to please" and Loos's "do not decorate" apply, and the architect slowly retreats from the "stage"... With luck, and with a creative builder, the architect can influence the space with the choice of interior and art, together they can combine it, regroup it, supplement it and thereby create.

Such a process, such "selection", then becomes a kind of prism, fragmenting light into individual "visible" colours and facilitating a great game with combinations of colours.

The organised, rational world of architecture and the expressive aspect of life, art, go together to make up the space, in which you are then reflected at a given time, and meditate on your existence, look at yourself and the world under the sway of a particular environment, and contemplate...

PETR KOLÁŘ
architect

Colour and character

In his choice of colours, the designer to a considerable extent defines the character of the product. Clear, sharp colours are received positively by a different public than grey shades.

In my opinion, professional furniture should not stand out too much. There is no reason to use striking colours; even without them, good furniture plays an important role in the atmosphere the furnishings create.

The choice of colour for furniture is closely related to the building's exterior and the materials used. Interior and exterior must be balanced. Light plays an important role here. North-facing rooms, letting in daylight, have a quite different character, often cooler, than warm, south-facing rooms. Buildings with low, large open floors and much artificial lighting have a different atmosphere than buildings with high ceilings.

A furniture designer must take care that the colour palette amplifies or supports a room's atmosphere.

With small products, such as accessories or upholstery, the atmosphere can be further simplified or personalised. The final effect is determined by the sum of all parts, a symbiosis of the forms and colours of the building and the furnishings.

HANS VERBOOM
designer

INTEGRATE COLOURS

The finish of the desktop and frame can be specified separately to match the interior décor and create the working environment required by the customer.

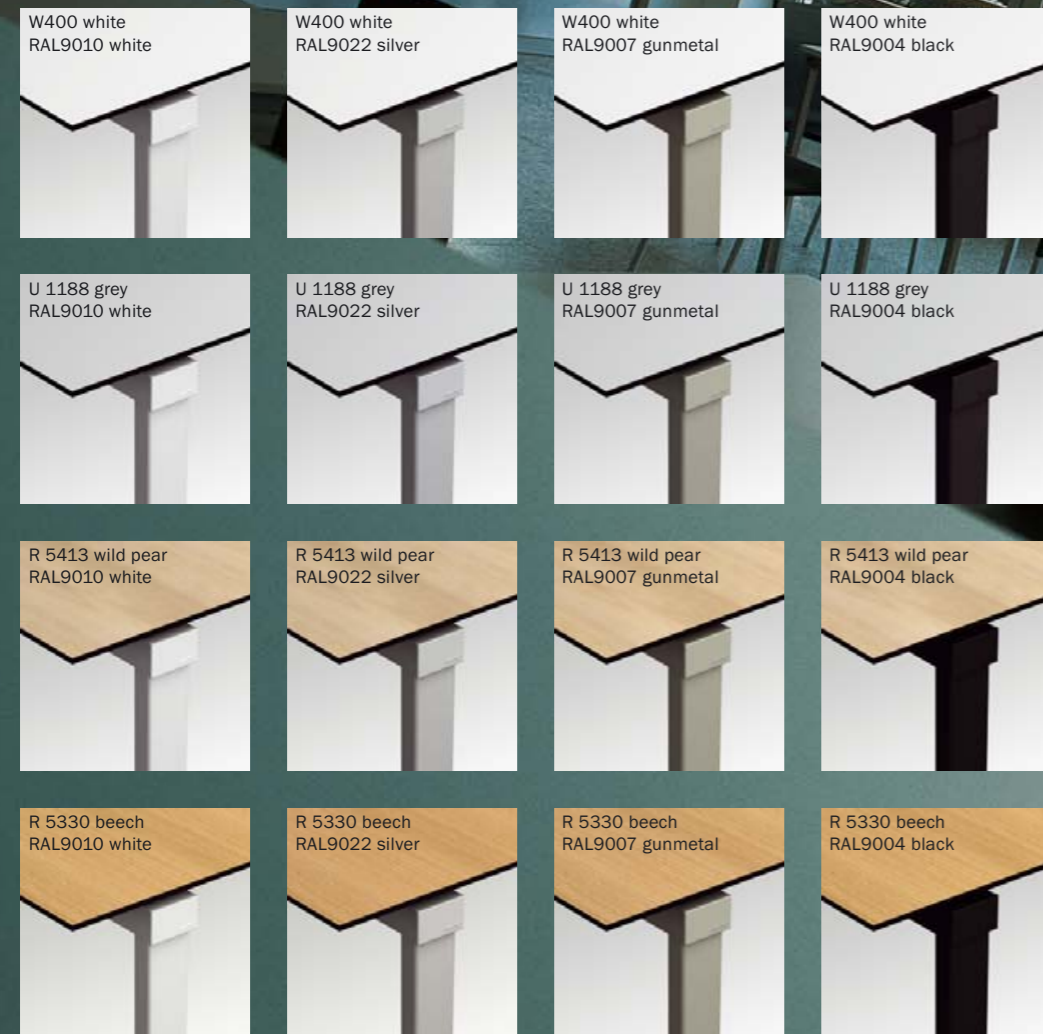

EKOTECH worksurface and frame combinations

MFC worksurface and frame combinations





TECHO

Techo has long been the leader in furnishing commercial interiors in Central Europe. Our bottom line extends further than just making a profit. We have been a key player in bringing our region into line with international standards of environmental sustainability and making office workers' lives more comfortable through ergonomically sound design. Techo has won many of the most important interior fit-out projects in Prague, such as: the Czech National Bank, O2 Arena (Prague's only major



modern sports and entertainment arena), and the headquarters of CEZ (electricity generator and the largest Czech company). As a dominant player in the CEE region, Techo supplies Austria's Erste Bank with all its branch furniture. A major proportion of its production output is now exported, including orders for Procter & Gamble in Africa and an established presence in Great Britain, now the second largest market for Techo products.



“ It is the quality and flexibility of our products and services, and the reputation we now have among customers and dealers, that make TECHO special. Our awareness of this fact drives all our dealings with clients. “

JIRÍ KEJVAL
TECHO

